

Edmond Crossing

20 - 78 E 33rd Street, Edmond, OK 73013



RETAIL SPACE NOW AVAILABLE

Available SF: 2,000 - 55,000 SF

Suite 24 (separate flyer) Available 55,000 SF

Suite 58 Available 3,000 SF

Suite 60 Available 3,000 SF

Suite 74 Available 2,000 SF

Suite 76 Available 2,000 SF

Lease Rate: Negotiable

Building Size: 151,664 SF

Year Built: 1995

PROPERTY OVERVIEW

Edmond Crossing is a Center ideally located at one of the busiest retail intersection in Edmond, with excellent access and co-tenancy.

Located on E 33rd Street (Immediately east of Broadway Extension)

Tenants include: TJ Maxx, Tuesday Morning, Cato, Party Galaxy, Chick-fil-A McDonalds, Taco Bell, Aaron's, GNC, Jason's Deli, and many more.

100217

FOR MORE INFORMATION, CONTACT

Ev Ernst
ernst@pricedwards.com
405.843.7474
210 Park Ave, Suite 700
Oklahoma City, OK 73102
www.pricedwards.com

George Williams
gwilliams@pricedwards.com
405.239.1270
210 Park Ave, Suite 700
Oklahoma City, OK 73102
www.pricedwards.com

Edmond Crossing

20 - 78 E 33rd Street, Edmond, OK 73013



DEMOGRAPHICS (per 2010 Census; 5 Miles Radius)

Total Population	130,524
Population Density	130,524
Median Age	33.0
Median Age (Male)	31.4
Median Age (Female)	34.4
Total Households	50,834
# of Persons Per HH	2.6
Average HH Income	\$79,536
Average House Value	\$203,101

TRAFFIC COUNTS (per ACOG)

Broadway	north	40,318
Broadway	south	41,600
E 33rd St	east	27,006
E 33rd St	west	18,871

The information above has been obtained from sources believed reliable. While we do not doubt its accuracy, we have not verified it and make no guarantee, warranty, or representation about it. You and your legal and technical advisors should conduct a careful, independent investigation of the property to determine to your satisfaction to the suitability of the property for your needs.

Edmond Crossing

20 - 78 E 33rd Street, Edmond, OK 73013

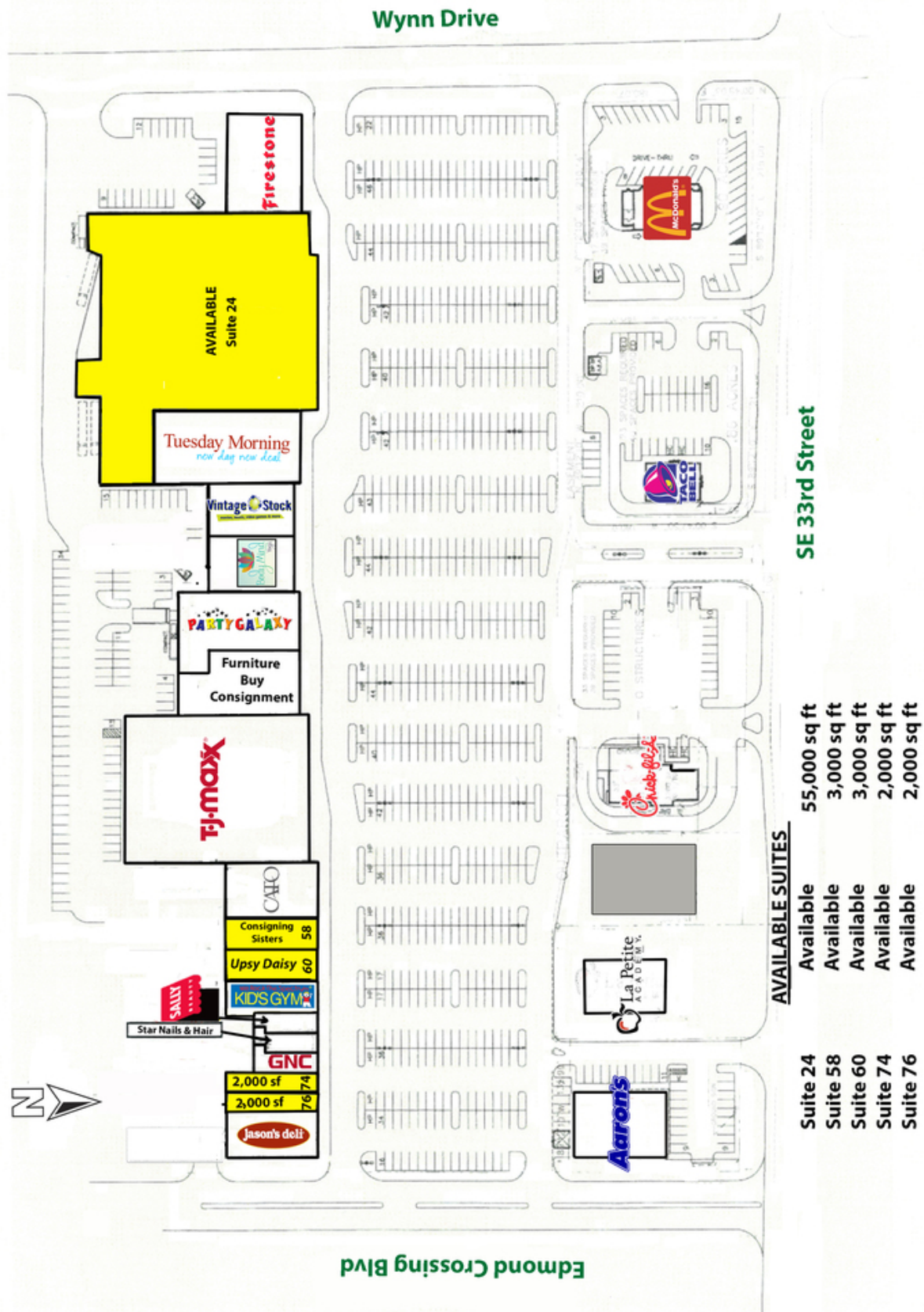

SE 33rd Street

AVAILABLE SUITES

Suite 24	Available	55,000 sq ft
Suite 58	Available	3,000 sq ft
Suite 60	Available	3,000 sq ft
Suite 74	Available	2,000 sq ft
Suite 76	Available	2,000 sq ft

Edmond Crossing

20 - 78 E 33rd Street, Edmond, OK 73013

